

# ROUILLARD

## GUIDE D'INSTALLATION INSTALLATION GUIDE

### SYSTÈME D'ANCRAGE / ANCHORING SYSTEM

AGORA.CAMPUS.QUANTUM. EVA LOUNGE

#### Outils / Tools



#### AGORA Quincaillerie / Hardware



Vis à béton / Concrete screw  
3/16" x 1.75"



Vis / Screw socket  
5/16-18 x 1-1/4"



Vis / Screw allen  
10-24 x 3/16"



#### CAMPUS Quincaillerie / Hardware



Vis à béton / Concrete screw  
3/16" x 1.75"



Vis fraisé / Countersunk Screw  
5/16-18 x 1-1/4"



Vis / Screw allen  
10-24 x 3/16"

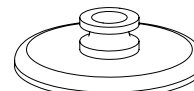
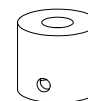

#### QUANTUM Quincaillerie / Hardware



Vis à béton / Concrete screw  
3/16" x 1.75"



Vis fraisé / Countersunk Screw  
5/16-18 x 1-1/4"



Vis / Screw allen  
10-24 x 3/16"

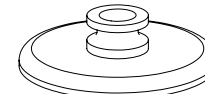
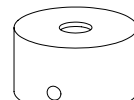

#### EVA LOUNGE Quincaillerie / Hardware



Vis à béton / Concrete screw  
3/16" x 1.75"



Vis / Screw socket  
1/4-20 x 1"



Vis / Screw allen  
10-24 x 3/16"

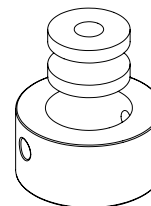

X1

# ROUILLARD

## GUIDE D'INSTALLATION INSTALLATION GUIDE

### SYSTÈME D'ANCRAGE / ANCHORING SYSTEM

AGORA

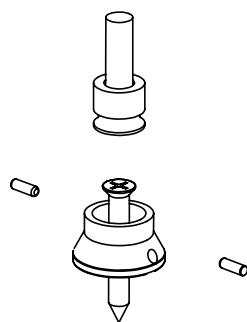
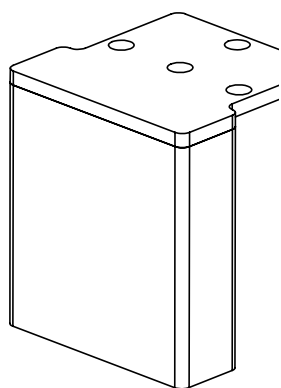
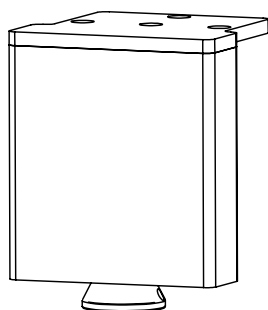

CAMPUS

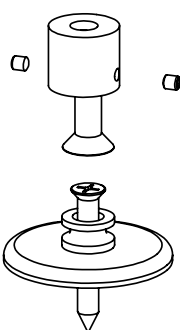
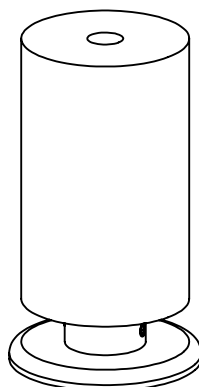

QUANTUM

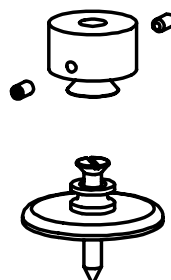
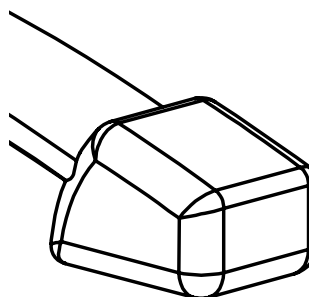
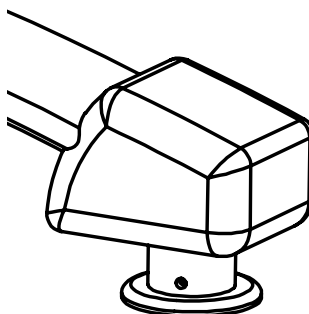

EVA LOUNGE

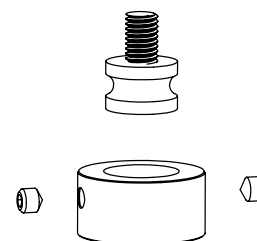
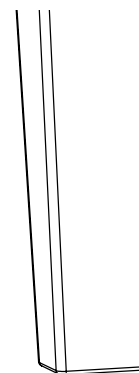
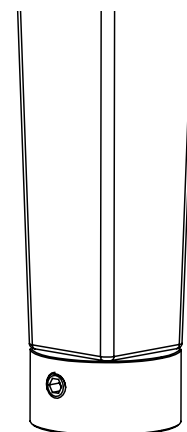

# ROUILLARD

## GUIDE D'INSTALLATION INSTALLATION GUIDE

### SYSTÈME D'ANCRAGE / ANCHORING SYSTEM

#### Étape /Step 1

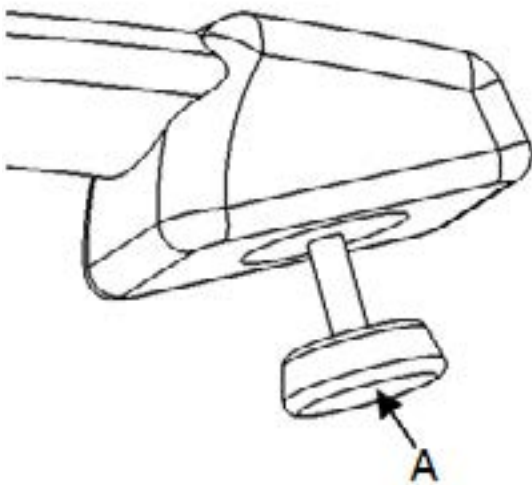

**A :** Enlever les sous-pattes en dévissant celle-ci. Disposez des sous-pattes.

**A :** Remove the glide from the legs and dispose of them

#### Étape /Step 2

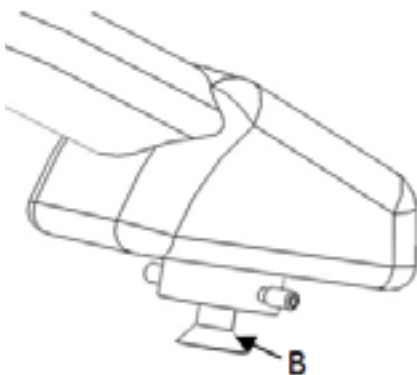

**B :** Fixez le socle dans la patte avec la vis.

**C :** Fixez le socle à la sous patte en vissant les vis avec la clé Allen.

**B :** Fix the pedestal in the leg with the screw.

**C :** To install the leg to the glide, with the allen key.

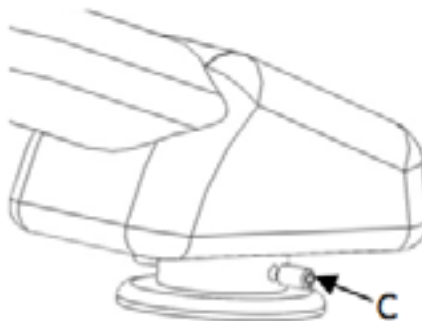

# ROUILLARD

## GUIDE D'INSTALLATION INSTALLATION GUIDE

### SYSTÈME D'ANCRAGE / ANCHORING SYSTEM

#### Étape /Step 3

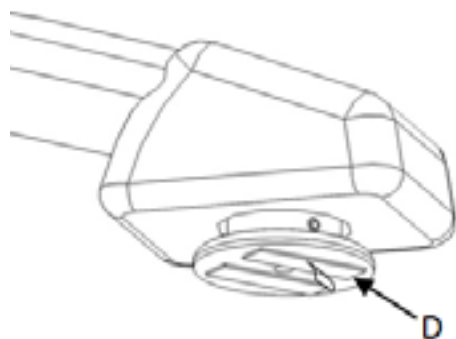

**D :** Retirez la bande ciré du ruban adhésif double-face et positionnez le banc publique à l'endroit désiré

**E :** Dévissez les 2 vis, soulevez le banc et laissez le glide au sol

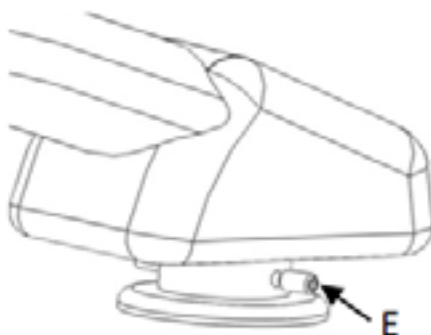

**D :** Remove the double-face adhesive tape and place the bench in its position

**E :** Remove the two screws, lift the bench, leave the glide on the floor

#### Étape /Step 4

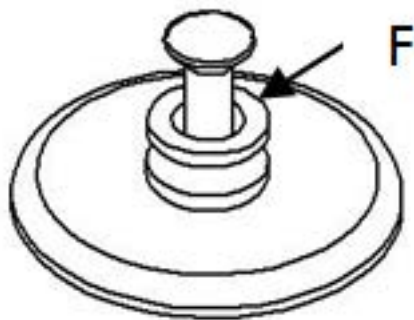

**F :** Fixez la sous-patte dans le plancher avec la vis à béton, en faisant préalablement un pré-trou avec la mèche 5/32"

**G :** Fixez le socle à la sous patte en vissant avec la clé Allen 3/32

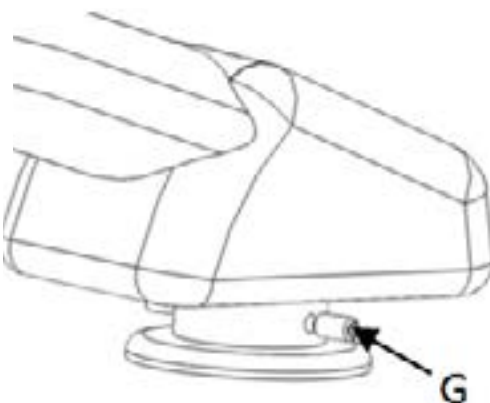

**F :** Use a 5/32" drill bit to drill a pre-hole and fix the glide to the floor with the concrete screw

**G :** To install the leg to the glide, with the Allen key